

Datasheet

Qioptiq Standard Collimators

Qioptiq fiber systems employ factory set optical coupler and collimator units which are precision aligned to minimize the beam position and beam angle. The standard footprints for an Ø0.7mm collimated beam are represented here.

Standard Collimator Ø12 x 50 mm

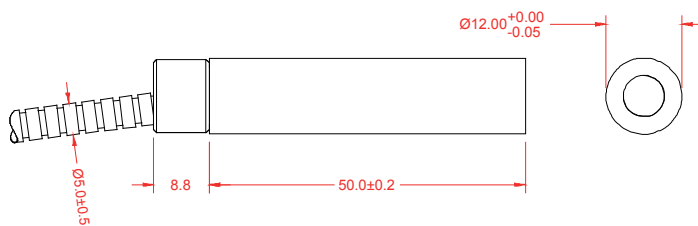

Short Collimator Ø12 x 25 mm

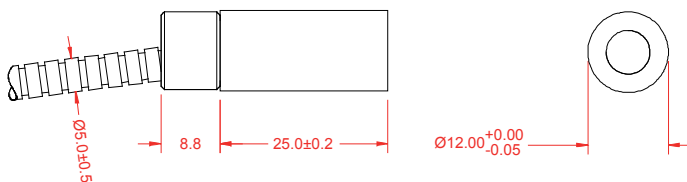

Mini Collimator Ø6 x 22 mm

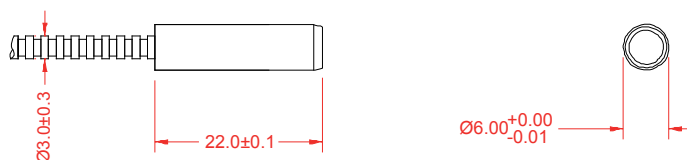

Tolerances Explained

Beam position or Eccentricity



Beam position or eccentricity is a measure of the near-field offset of the mechanical and optical axes of the optical coupler

Beam angle or Concentricity



Beam angle or concentricity is a measure of the far-field angular deviation between the mechanical and optical axes of the optical coupler

For further information please contact:

Qioptiq, Mitchell Point, Ensign Way, Hamble, Hampshire, SO31 4RF
 Email: sales@qpl.qioptiq.com
 Tel: +44 (0) 23 80 744 500 Fax: +44 (0) 23 80 744 501
www.qioptiq.com

www.qioptiq.com/diode-lasers
www.qioptiq.com/fiber-optics

Copyright ©2011 Qioptiq Photonics Ltd.
 Qioptiq Photonics Ltd. follows a policy of continuous improvement. Specifications are subject to change without notification.

