

Frame Grabber and Simulator Hardware Reference & Installation Guide

May 2020 - Rev 1.0



www.kayainstruments.com

20 HaMesila St., Nesher 3688520, Israel
POB 25004, Haifa 3125001, Israel
Tel:(+972)-72-2723500 Fax:(+972)-72-2723511

Table of Contents

1	Figures and Tables	2
1.1	List of figures	2
1.2	List of tables	2
2	Revision history	3
3	Introduction	4
3.1	Safety precautions	4
3.2	Disclaimer	5
4	Document Scope	6
5	Card Overview	7
5.2	Chameleon II Connectors and LEDs Layout	7
5.3	Komodo II CoaXPress Connectors and LEDs Layout	8
5.4	Komodo II CLHS Connectors and LEDs Layout	8
6	PCIe Working Modes	9
7	Card LEDs	10
7.1.1	Connector LEDs	10
7.1.2	Board Status LEDs	10
8	CoaXPress Cables	11
9	General Purpose Input Output	12
9.1	GPIO Connectors	12
9.2	GPIO Pinout	12
9.3	GPIO Output / Input	13
9.3.1	LVDS Inputs	13
9.3.2	LVDS Outputs	13
9.3.3	TTL Inputs/Outputs	14
9.3.4	LTTL Inputs/Outputs	14
9.3.5	Isolated Input	15
9.3.6	Isolated Output	16
10	Mechanical Specifications	17
10.1	Mechanical Drawings	17
10.1.1	Predator II CoaXPress Mechanical Drawing	17
10.1.2	Chameleon II CoaXPress / Komodo II CoaXPress Mechanical Drawing	17
10.1.3	Komodo II CLHS Mechanical Drawing	18
10.2	Weight & Environmental Conditions	19
11	Power Specification	20
11.1	Absolute Maximum Ratings	20
12	Installation & Configuration	21
12.1	Installation Instructions	21
12.2	CoaXPress Cards	21
12.2.1	Installing and Removing Micro-BNC Cables	21
12.3	CLHS Cards	23
12.3.1	Installing & Removing SFP+ Modules	23
12.3.2	Precautions	23
12.3.3	Installing the SFP+ Module	23
12.3.4	Connecting the Interface Cable to the SFP+ Module	24
12.3.5	Removing the SFP+ Module	25
12.4	Camera Connection Topologies	25

1 Figures and Tables

1.1 List of figures

Figure 1 – Predator II connector topology	7
Figure 2 – Chameleon II connector topology	7
Figure 3 – Komodo II CoaXPress connector topology	8
Figure 4 – Komodo II CLHS connector topology.....	8
Figure 5 – GPIO connector schematics	12
Figure 6 – LVDS inputs schematics.....	13
Figure 7 – LVDS inputs schematics.....	13
Figure 8 – LVDS inputs/outputs schematics.....	14
Figure 9 – LVDS inputs/outputs schematics.....	14
Figure 10 – Isolated input schematics.....	15
Figure 11 – Isolated output schematics	16
Figure 12 – Pushing the Micro-BNC connector into place	22
Figure 13 – Twisting the connector and securing it in position.....	22
Figure 14 – SFP+ Module Installation.....	24
Figure 15 – Interface connecting to the SFP+ Module.....	24
Figure 16 – Removing the SFP+ Module	25
Figure 17 – Single camera topology	25
Figure 18 – Dual camera topology	25
Figure 19 – Quad camera topology.....	25

1.2 List of tables

Table 1 – Revision History	3
Table 2 – PCIe working modes	9
Table 3 – Connector indicator lamp states	10
Table 4 – Connector indication lamp timings.....	10
Table 5 – Status indicator lamp states	10
Table 6 – Typical link performance	11
Table 7 – GPIO connectors part numbers	12
Table 8 – GPIO connector pinout.....	12
Table 8 – LVDS inputs DC characteristics	13
Table 9 – LVDS inputs DC & AC characteristics	13
Table 10 – LVDS outputs DC characteristics.....	13
Table 11 – LVDS outputs AC characteristics.....	13
Table 12 – TTL inputs/outputs DC characteristics.....	14
Table 13 – TTL inputs/outputs AC characteristics	14
Table 14 – LTTL inputs/outputs DC characteristics	14
Table 15 – LTTL inputs/outputs AC characteristics	15
Table 16 – Isolated input DC characteristics	15
Table 17 – Isolated input AC characteristics	15
Table 18 – Isolated output DC characteristics.....	16
Table 19 – Isolated output AC characteristics.....	16
Table 21 – Card's weight.....	19
Table 22 – Absolute maximum temperature ratings	19
Table 23 – Absolute maximum electrical ratings	20
Table 24 – Absolute maximum ratings for GPIO	20

2 Revision history

Version	Date	Notes
1.0	07.05.2020	Initial release

Table 1 – Revision History

3 Introduction

3.1 Safety precautions

With your card in hand, please take the time to read through the precautions listed below in order to prevent preventable and unnecessary injuries and damage to you, other personnel or property. Read these safety instructions carefully prior to your first use of the product, as these precautions contain safety instructions that must be observed. Be sure to follow this manual in order to prevent misuse of product.



Caution! Read Carefully and do not disregard these instructions.

In the event of a failure, disconnect the power supply

Disconnect the power supply immediately and contact our sales personnel for repair. Continuing to use the product in this state may result in a fire or electric shock.

If an unpleasant smell or smoking occurs, disconnect the power supply.

Disconnect the power supply immediately! Continuing to use the product in this state may result in a fire or electric shock. After verifying that no smoking is observed, contact our sales personnel for repair.

Do not disassemble, repair or modify the product.

This may result in a fire or electric shock due to a circuit shortage or heat generation. Contact our sales personnel prior to inspection, modification or repair.

Do not place the product on unstable surfaces.

Otherwise, it may drop or fall, resulting in injury to persons or the camera.

Do not use the product if dropped or damaged.

Otherwise, a fire or electric shock may occur.

Do not touch the product with metallic objects.

Otherwise, a fire or electric shock may occur.

Do not place the product in dusty or humid environments, nor where water may splash.

Otherwise, a fire or electric shock may occur.

Do not wet the product or touch it with wet hands.

Otherwise, the product may fail or it may cause a fire, smoking or electric shock.

Do not touch the gold-plated sections of the connectors on the product.

Otherwise, the surface of the connector may be contaminated by sweat or skin-oil, resulting in contact failure of a connector, malfunction, fire or electric shock due to static electricity discharge.

Do not use or place the product in the following locations.

- Unventilated areas such as closets or bookshelves.
- Near oils, smoke or steam.
- Next to heat sources.
- A closed (and not running) car where the temperature becomes high.
- Static electricity replete locations
- Near water or chemicals.

Otherwise, a fire, electric shock, accident or deformation may occur due to a short circuit or heat generation.

Do not place heavy objects on the product.

Otherwise, the product may be damaged.

Be sure to discharge static electricity from body before touching any sensitive electronic components.

The electronic circuits in your computer and the circuits on the *Iron* camera and the *Predator II* board are sensitive to static electricity and surges. Improper handling may seriously damage the circuits. In addition, do not let your clothing come in contact with the circuit boards or components. Otherwise, the product may be damaged.

3.2 Disclaimer

KAYA Instruments will assume no responsibility for any damage that may ensue by the use of this product for any purpose other than intended, as previously stated. Without detracting from what was previously written, please be advised that the company will take no responsibility for any damages caused by:

- Earthquake, thunderstrike, natural disasters, fire caused by use beyond our control, wilful and/or accidental misuse and/or use under other abnormal and/or unreasonable conditions.
- Secondary damages caused by the use of this product or its unusable state (business interruption or others).
- Use of this product in any manner that contradicts this manual or malfunctions that may occur due to connection to other devices. Damage to this product that is out of our control or failure due to modification
- Accidents and/or third parties that may be involved.

Additionally, **KAYA Instruments** assumes no responsibility or liability for:

- Erasure or corruption of data caused by the use of this product.
- Any consequences or other abnormalities following the use of this product

Repairs to this product are carried out by replacing it on a chargeable basis and not by repairing the faulty device. Non-chargeable replacement is offered for initial failure, as long as it is reported no later than two weeks post delivery of the product.

4 Document Scope

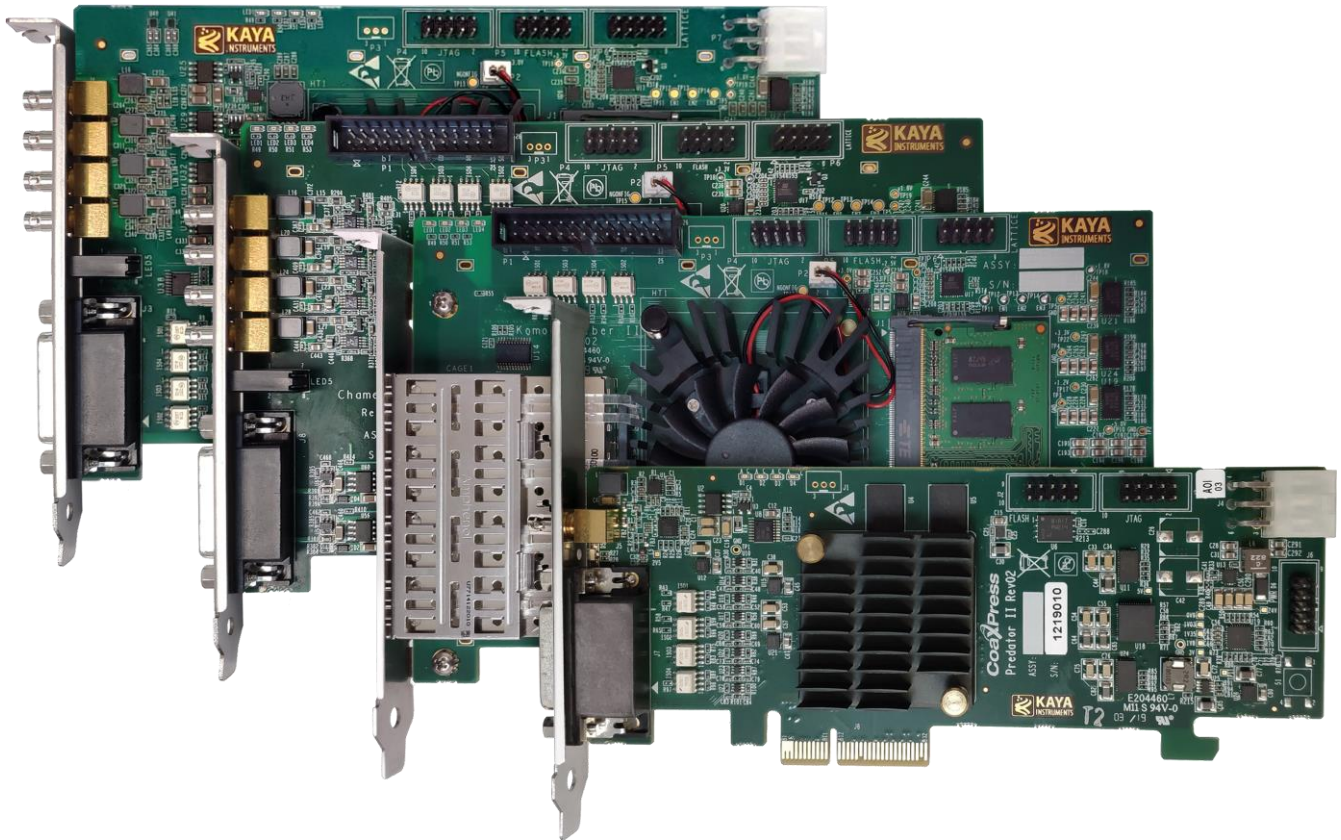

This document is meant to serve as a hardware reference and installation guide for KAYA's second generation frame grabbers: the Predator II CoaXPRESS, Komodo II CoaXPRESS, Komodo II CLHS and Chameleon II.

The guide consists of 8 chapters split into two main parts: the first (chapters 5 through 11) refers to the hardware of the cards and includes an overview and interface layouts, PCIe working modes, LED states, GPIO connectors and pinout, mechanical drawings, environmental conditions and electrical specifications. The second part refers to the installation and set-up process for each of the cards.

Please feel free to contact our team over at support@kayainstruments.com with any questions that may arise.

5 Card Overview

5.1 Predator II CoaXPress Connectors and LEDs Layout

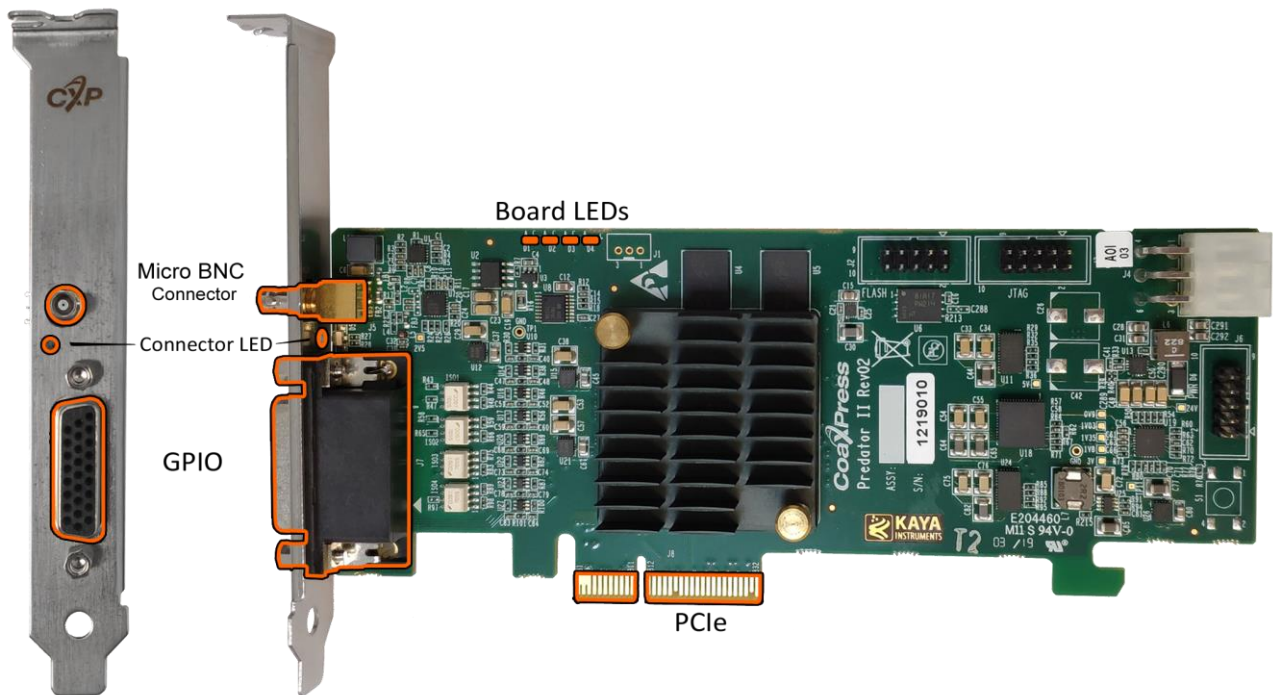

Figure 1 – Predator II connector topology

5.2 Chameleon II Connectors and LEDs Layout

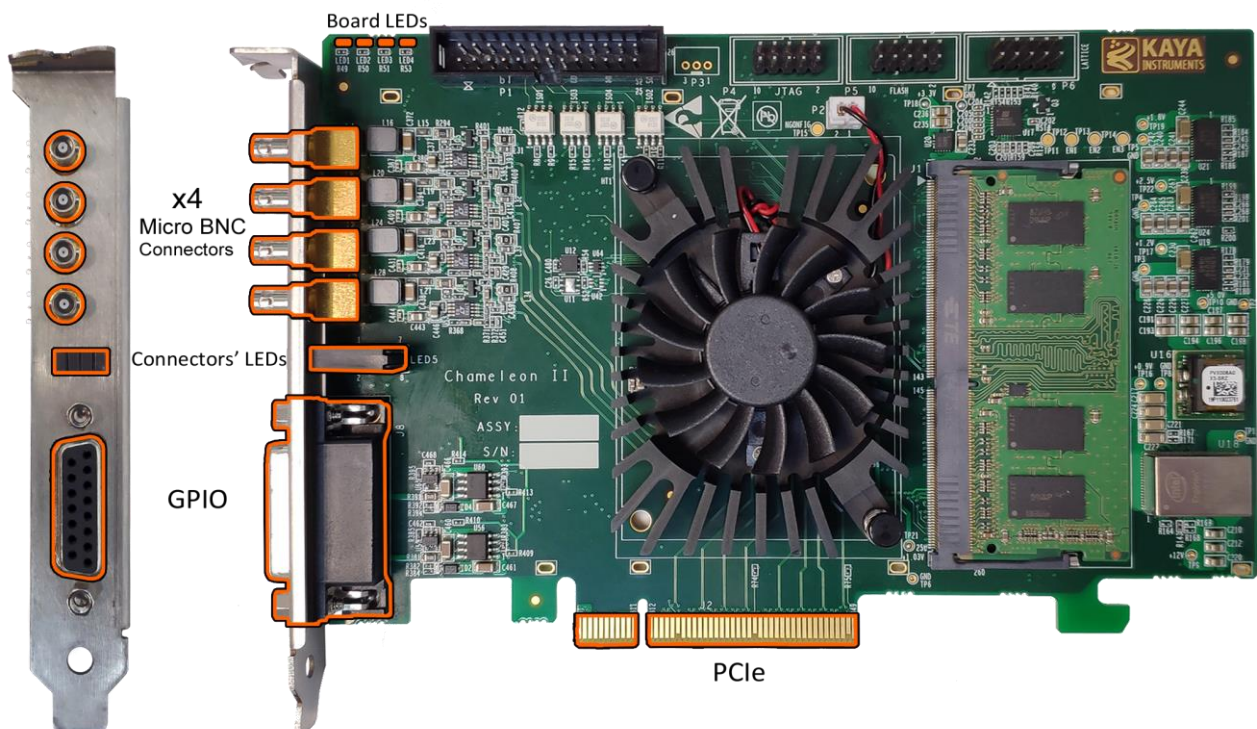

Figure 2 – Chameleon II connector topology

5.3 Komodo II CoaXPress Connectors and LEDs Layout

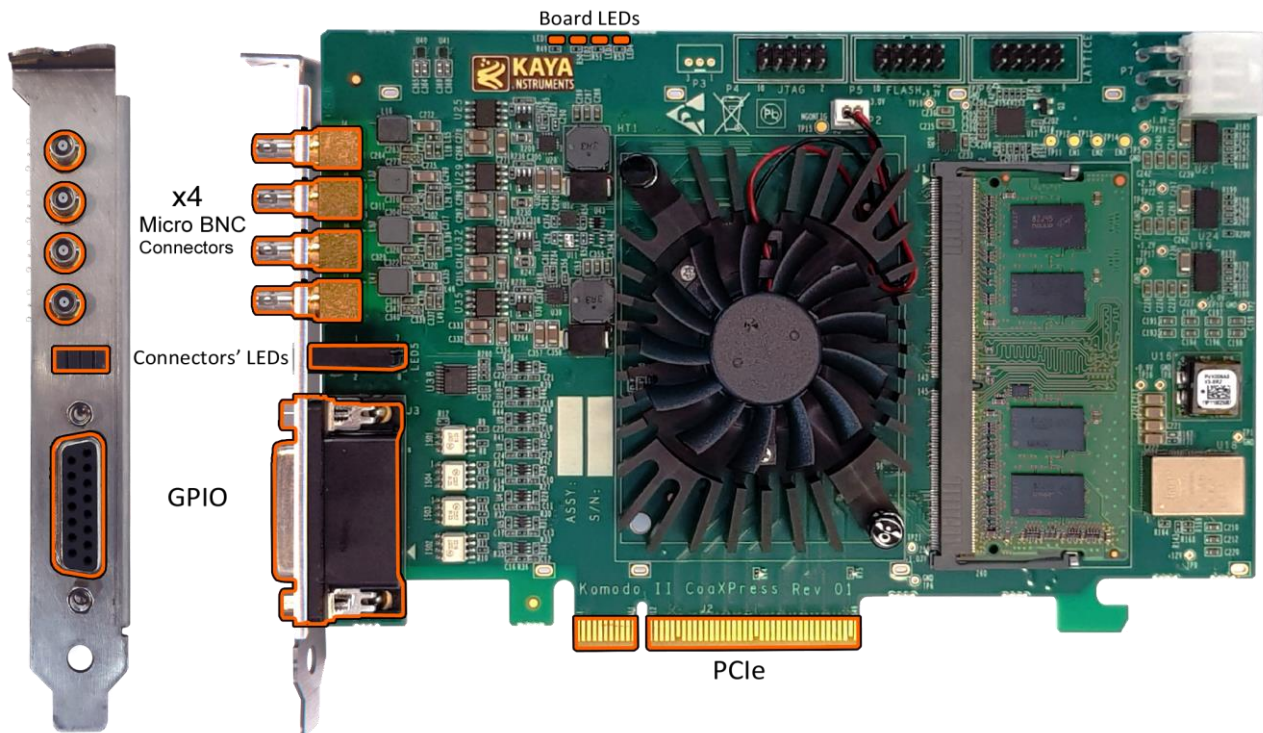

Figure 3 – Komodo II CoaXPress connector topology

5.4 Komodo II CLHS Connectors and LEDs Layout

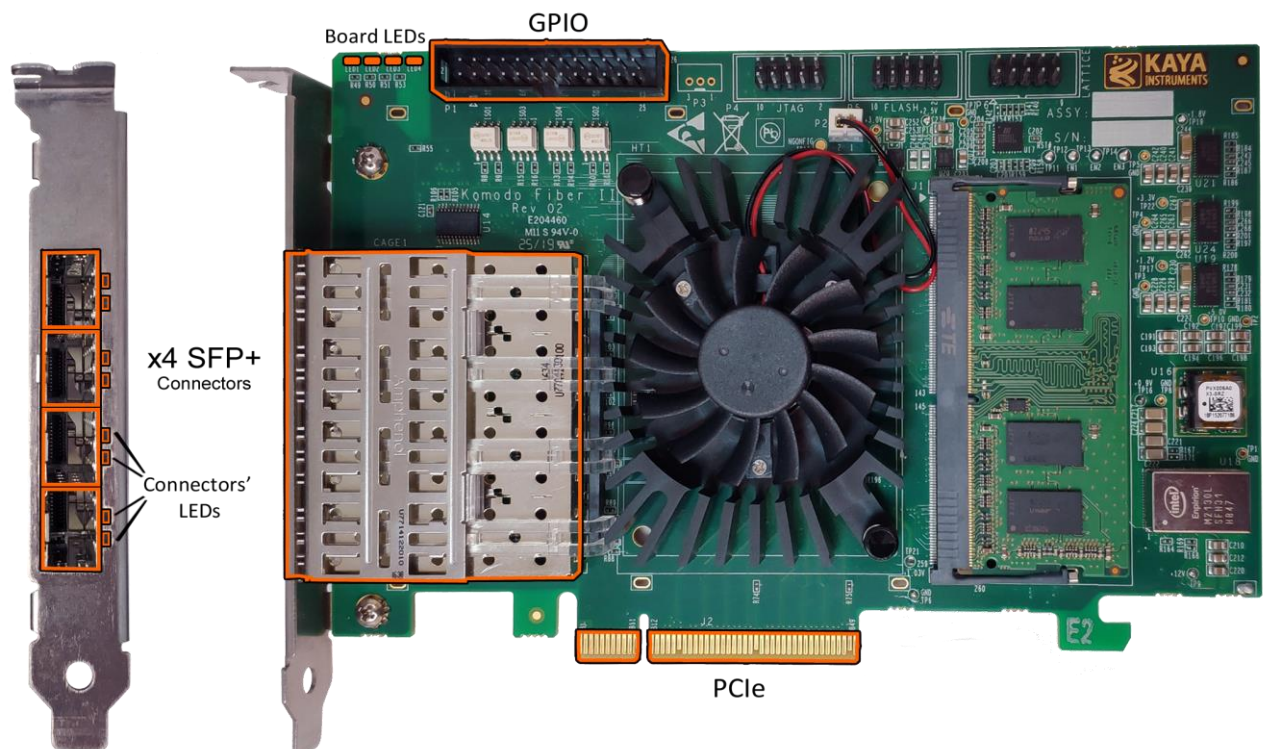

Figure 4 – Komodo II CLHS connector topology

6 PCIe Working Modes

Newest PCIe generations supported and maximal bandwidth for each card are listed in the following table:

Card	Newest Supported PCIe Generation	Maximal Bandwidth (Newest PCIe Generation)
Predator II CoaXPress	Gen 2.4, up to 4 lanes	12 [Gbps]
Chameleon II CoaXPress	Gen 3, up to 8 lanes	40 [Gbps]
Komodo II CoaXPress	Gen 3, up to 8 lanes	55 [Gbps]
Komodo II CLHS	Gen 3, up to 8 lanes	55 [Gbps]

Table 2 – PCIe working modes

7 Card LEDs

7.1.1 Connector LEDs

The bi-color LEDs behave according to definition in section 5.4 of the CoaXPress standard. Color-coded indication along with exact timing for each indicator are shown in the following tables:









LED state	Indication
 Solid green	Camera is connected, no data being transferred
 Fast flash green	Camera is connected, data is being transferred
 Fast flash alternate green / orange	Connection detection in progress, PoCXP active
 Slow flash alternate green / orange	Connection test packets being sent
 Solid orange	System is not initialized
 Slow pulse orange	Camera connected. Waiting for trigger event
 Fast flash orange	Connection detection in progress, PoCXP not in use
 Slow pulse red	No camera is connected
 Solid red	PoCXP over-current

Table 3 – Connector indicator lamp states



Indication	Timing
 Fast flash	12.5Hz (20ms on, 60ms off)
 Slow flash	0.5Hz (1s on, 1s off)
 Slow pulse	1Hz (200ms on, 800ms off)

Table 4 – Connector indication lamp timings

7.1.2 Board Status LEDs

LED	Description
0	Alive led. Blinks when the board receives clock from PCIe
1	PCIe L0 state. When lit, indicates that the PCIe interface is powered up at active state.
2	Maximum supported PCIe gen indicator. When lit indicates that PCIe is working as Gen3 (2.4 for the Predator II CoaXPress) When not lit the boards works either as PCIe Gen1 or Gen2 (or just PCIe Gen1 for the Predator II CoaXPress).
3	Lane's indicator. When lit, indicates that all PCIe lanes are up. If not lit, one or four lanes are up (only one for the Predator II CoaXPress).

Table 5 – Status indicator lamp states

8 CoaXPress Cables

CoaXPress is a new digital transmission standard that allows high speed data from a device, such as a camera, to be transferred to a host, such as a frame grabber. Each CoaXPress link supports up to 12.5 Gbps data rates, along with device power up to 13W and device control at up to 30 Mbps – all on a single coax cable. For very fast devices, the links can be aggregated to provide multiples of the single coax bandwidth. Long cable lengths are supported – up to 30 meters at 12.5Gbps and over 100 meters at 3.125 Gbps.

Table 6 gives an overview of typical link performance at room temperature for the link between two FMX II CoaXPress boards, using the downlink channel, uplink channel and power transmission simultaneously.



BELDEN	Name	Belden 7731A	Belden 1694A	Belden 1505A	Belden 1505F	Belden 1855A
	Type	Long Distance	Industry Standard	Compromise	Flexible	Thinnest cable
Diameter	(mm)	10.3	6.99	5.94	6.15	4.03
1.25 Gbps	(m)	194	130	107	80	55
2.5 Gbps	(m)	162	110	94	66	55
3.125 Gbps	(m)	147	100	86	60	55
5.0 Gbps	(m)	87	60	52	35	38
6.25 Gbps	(m)	58	40	35	23	25
10 Gbps	(m)	TBD	40	TBD	TBD	TBD
12 Gbps	(m)	TBD	30	TBD	TBD	TBD
	Length					

GEPKO	Name	Gepco VHD1100	Gepco VSD2001	Gepco VPM2000	Gepco VHD2000M	Gepco VDM230
	Type	Long Distance	Industry Standard	Compromise Coax	Flexible	Thinnest cable
Diameter	(mm)	10.3	6.91	6.15	6.15	4.16
1.25 Gbps	(m)	212	140	109	81	66
2.5 Gbps	(m)	185	120	94	67	66
3.125 Gbps	(m)	169	110	86	61	62
5.0 Gbps	(m)	102	66	53	36	38
6.25 Gbps	(m)	68	44	35	24	25
10 Gbps	(m)	TBD	TBD	TBD	TBD	TBD
12 Gbps	(m)	TBD	TBD	TBD	TBD	TBD
	Length					

Table 6 – Typical link performance

9 General Purpose Input Output

9.1 GPIO Connectors

Our second-generation cards come with one of two possible GPIO connectors: the 26-pin, 3-row D-Sub connector accessible from the front bracket (Komodo II CoaXPress and Predator I CoaXPress) and the 26-pin, dual row pin header connector that is located on the PCB itself (Komodo II CLHS and Chameleon II CoaXPress).

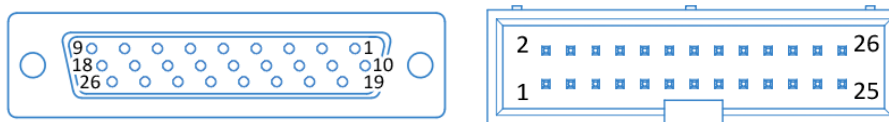

Figure 5 – GPIO connector schematics
3-row D-Sub connector (left) and dual row pin header (right)

Connector	Manufacturer's Part Number
26-pin, 3-row D-Sub	181-026-213R561
26-pin, dual row pin header	CH87262V200

Table 7 – GPIO connectors part numbers

9.2 GPIO Pinout

The pinout for each of these connectors is as described:

Pin	Signal Name	Function	Electrical	Description
1	LVDS Input Op	LVDS input	LVDS	Positive signal of LVDS pair
2	LVDS Input On	LVDS input	LVDS	Positive signal of LVDS pair
3	LVDS Input 1p	LVDS input	LVDS	Negative signal of LVDS pair
4	LVDS Input 1n	LVDS input	LVDS	Negative signal of LVDS pair
5	LVDS Output Op	LVDS output	LVDS	Positive signal of LVDS pair
6	LVDS Output On	LVDS output	LVDS	Positive signal of LVDS pair
7	LVDS Output 1p	LVDS output	LVDS	Negative signal of LVDS pair
8	LVDS Output 1n	LVDS output	LVDS	Negative signal of LVDS pair
9	Optocoupled Output 0	Opto-Isolated output	Up to 70V	Optically isolated outputs
10	Optocoupled Output 1	Opto-Isolated output	Up to 70V	Optically isolated outputs
11	Optocoupled Output 2	Opto-Isolated output	Up to 70V	Optically isolated outputs
12	Optocoupled Output 3	Opto-Isolated output	Up to 70V	Optically isolated outputs
13	Optocoupled Input 0	Opto-Isolated input	Up to 70V	Optically isolated inputs
14	Optocoupled Input 1	Opto-Isolated input	Up to 70V	Optically isolated inputs
15	Optocoupled Input 2	Opto-Isolated input	Up to 70V	Optically isolated inputs
16	Optocoupled Input 3	Opto-Isolated input	Up to 70V	Optically isolated inputs
17	Optocoupled GND	External GND		Ground signal for opto-isolated signals on this connector
18	GND	Board GND		Reference ground signal
19	TTL 0	GPIO	TTL (Open-drain)	General Purpose IO
20	TTL 1	GPIO	TTL (Open-drain)	General Purpose IO
21	TTL 2	GPIO	TTL (Open-drain)	General Purpose IO
22	TTL 3	GPIO	TTL (Open-drain)	General Purpose IO
23	LVTTL 0	GPIO	LVTTL	General Purpose IO
24	LVTTL 1	GPIO	LVTTL	General Purpose IO
25	LVTTL 2	GPIO	LVTTL	General Purpose IO
26	LVTTL 3	GPIO	LVTTL	General Purpose IO

Table 8 – GPIO connector pinout

9.3 GPIO Output / Input

9.3.1 LVDS Inputs

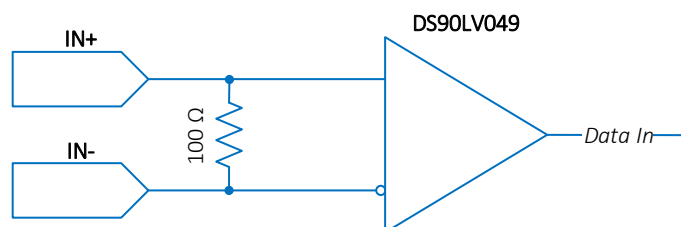

Figure 6 – LVDS inputs schematics

DC Characteristics:

Parameter	Conditions	Min	Typical	Max	Units
Common mode voltage		0.05		3	V
Differential sensitivity				100	mV
Input impedance			100		Ohm
ESD protection	HBM, 1.5 kΩ, 100 pF	7			kV
	MM, 0 Ω, 200 pF	250			V

Table 9 – LVDS inputs DC characteristics

AC Characteristics:

Parameter	Conditions	Min	Typical	Max	Units
Pulse width		50			ns
Pulse rate		0		5	MHz
10%-90% rise/fall time		0.3		1.4	ns

Table 10 – LVDS inputs DC & AC characteristics

9.3.2 LVDS Outputs

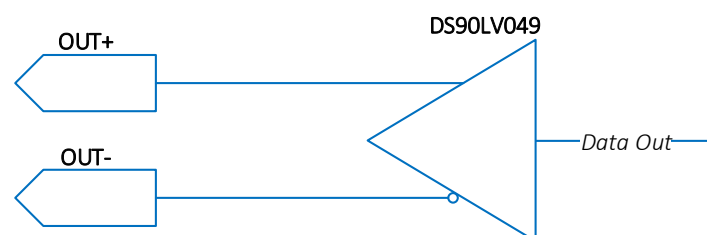

Figure 7 – LVDS outputs schematics

DC Characteristics:

Parameter	Conditions	Min	Typ	Max	Units
Common mode voltage		1.125	1.23	1.375	V
Differential output voltage		250	350	450	mV
Output Short Circuit			-5.8	-9	mA
ESD protection	HBM, 1.5 kΩ, 100 pF	7			kV
	MM, 0 Ω, 200 pF	250			V

Table 11 – LVDS outputs DC characteristics

AC Characteristics:

Parameter	Conditions	Min	Typ	Max	Units
Pulse width		50			ns
Pulse rate		0		5	MHz
10%-90% rise/fall time		0.2	0.4	1	ns

Table 12 – LVDS outputs AC characteristics

9.3.3 TTL Inputs/Outputs

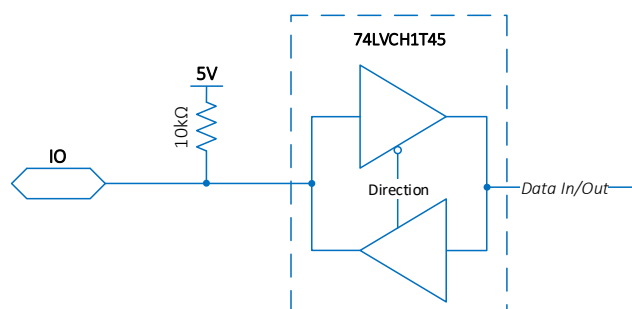

Figure 8 – LVDS inputs/outputs schematics

DC Characteristics:

Parameter	Conditions	Min	Typical	Max	Units
Low-level output current				50	mA
Low-level output voltage	IO = 32 mA			0.55	V
High-level output current				-50	mA
High-level output voltage	IO = -32 mA	3.8			V
Low-level input voltage				1.5	V
High-level input voltage		3.5			V
Absolute maximum input		-0.5		6.5	V
ESD protection	HBM JESD22-A114F	4			kV
	CDM JESD22-C101E	1			kV

Table 13 – TTL inputs/outputs DC characteristics

AC Characteristics:

Parameter	Conditions	Min	Typical	Max	Units
Pulse width		50			ns
Pulse rate		0		5	MHz

Table 14 – TTL inputs/outputs AC characteristics

9.3.4 LTTL Inputs/Outputs

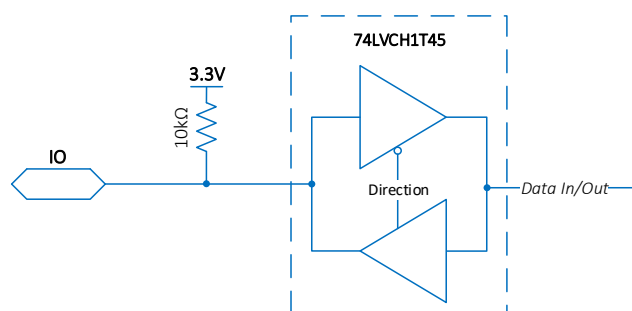

Figure 9 – LVDS inputs/outputs schematics

DC Characteristics:

Parameter	Conditions	Min	Typical	Max	Units
Low-level output current				50	mA
Low-level output voltage	IO = 24 mA			0.55	V
High-level output current				-50	mA
High-level output voltage	IO = -24 mA	2.4			V
Low-level input voltage				0.8	V
High-level input voltage		5			V
Absolute maximum input		-0.5		6.5	V
ESD protection	HBM JESD22-A114F	4			kV
	CDM JESD22-C101E	1			kV

Table 15 – LTTL inputs/outputs DC characteristics

AC Characteristics:

Parameter	Conditions	Min	Typical	Max	Units
Pulse width		50			ns
Pulse rate		0		5	MHz

Table 16 – LTTL inputs/outputs AC characteristics

9.3.5 Isolated Input

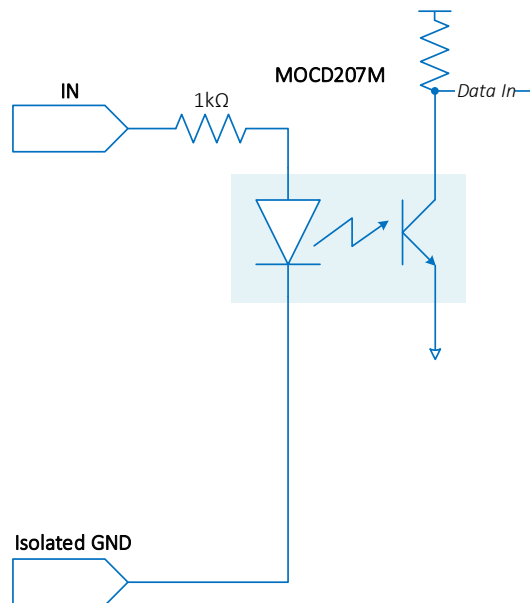

Figure 10 – Isolated input schematics

When input current exceeds the threshold, the input logic state is HIGH.

DC Characteristics:

Parameter	Conditions	Min	Typical	Max	Units
Input Voltage		-6		50	V
Input current threshold			3		mA
DC Isolation		250			V
AC Isolation		150			V _{RMS}

Table 17 – Isolated input DC characteristics

AC Characteristics:

Parameter	Conditions	Min	Typical	Max	Units
Pulse width		10			us
Pulse rate		0		5	KHz

Table 18 – Isolated input AC characteristics

9.3.6 Isolated Output

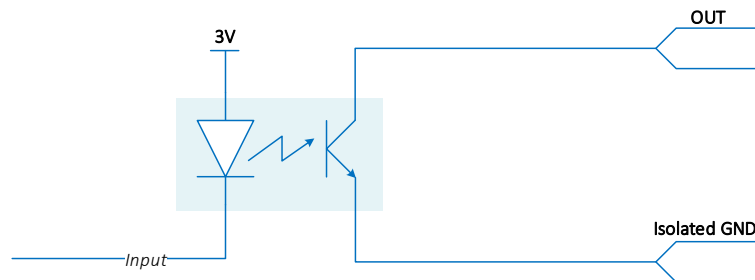

Figure 11 – Isolated output schematics

When logic state is HIGH the output is in conductive state (switch ON)

DC Characteristics:

Parameter	Conditions	Min	Typical	Max	Units
Input Voltage		-6		50	V
Input current threshold			3		mA
DC Isolation		250			V
AC Isolation		150			V _{RMS}

Table 19 – Isolated output DC characteristics

AC Characteristics:

Parameter	Conditions	Min	Typical	Max	Units
Pulse width		10			us
Pulse rate		0		5	KHz

Table 20 – Isolated output AC characteristics

10 Mechanical Specifications

10.1 Mechanical Drawings

10.1.1 Predator II CoaXPress Mechanical Drawing

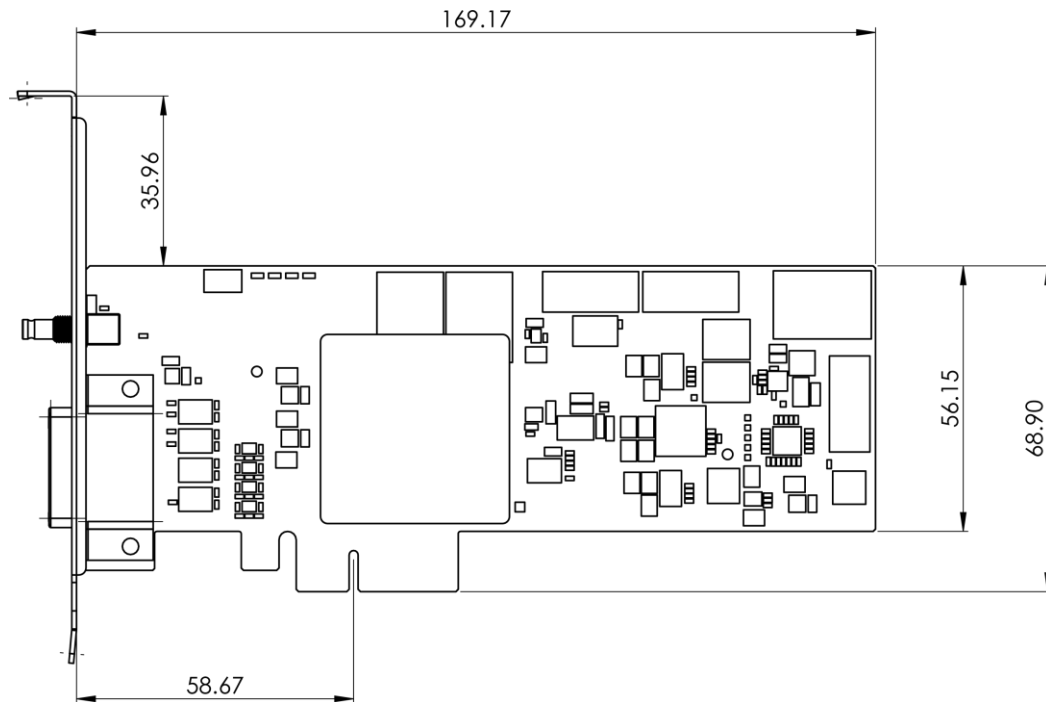

10.1.2 Chameleon II CoaXPress / Komodo II CoaXPress Mechanical Drawing

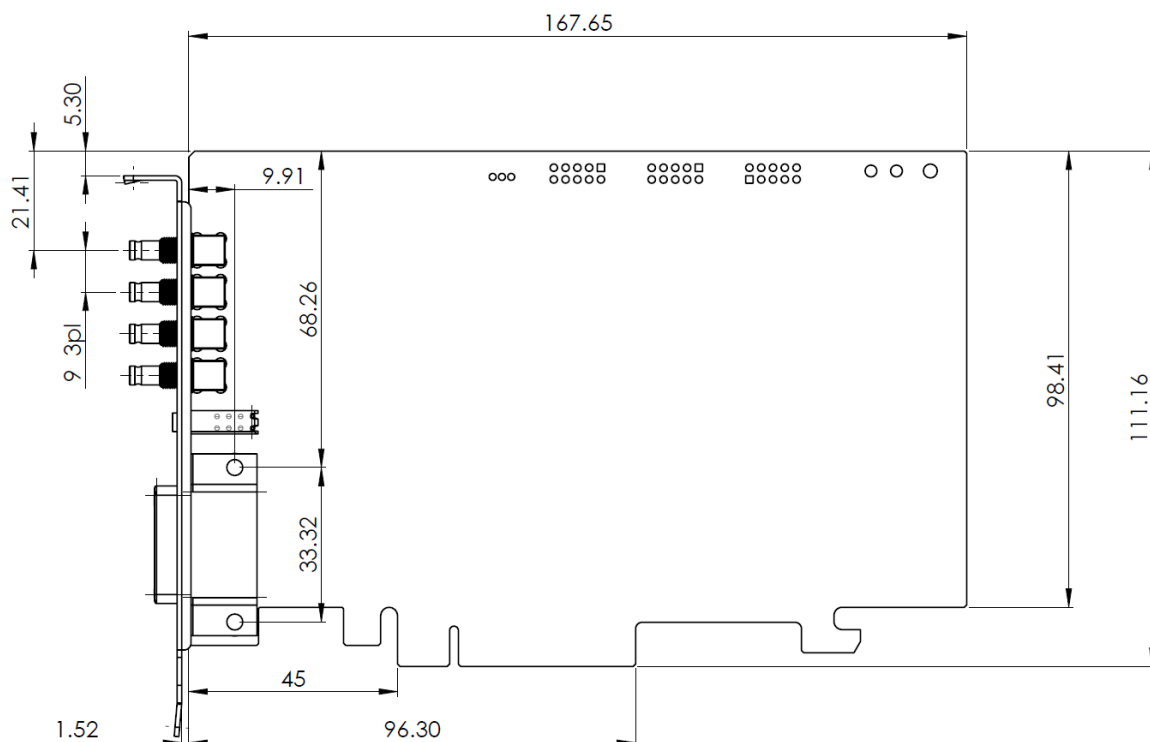

10.1.3 Komodo II CLHS Mechanical Drawing

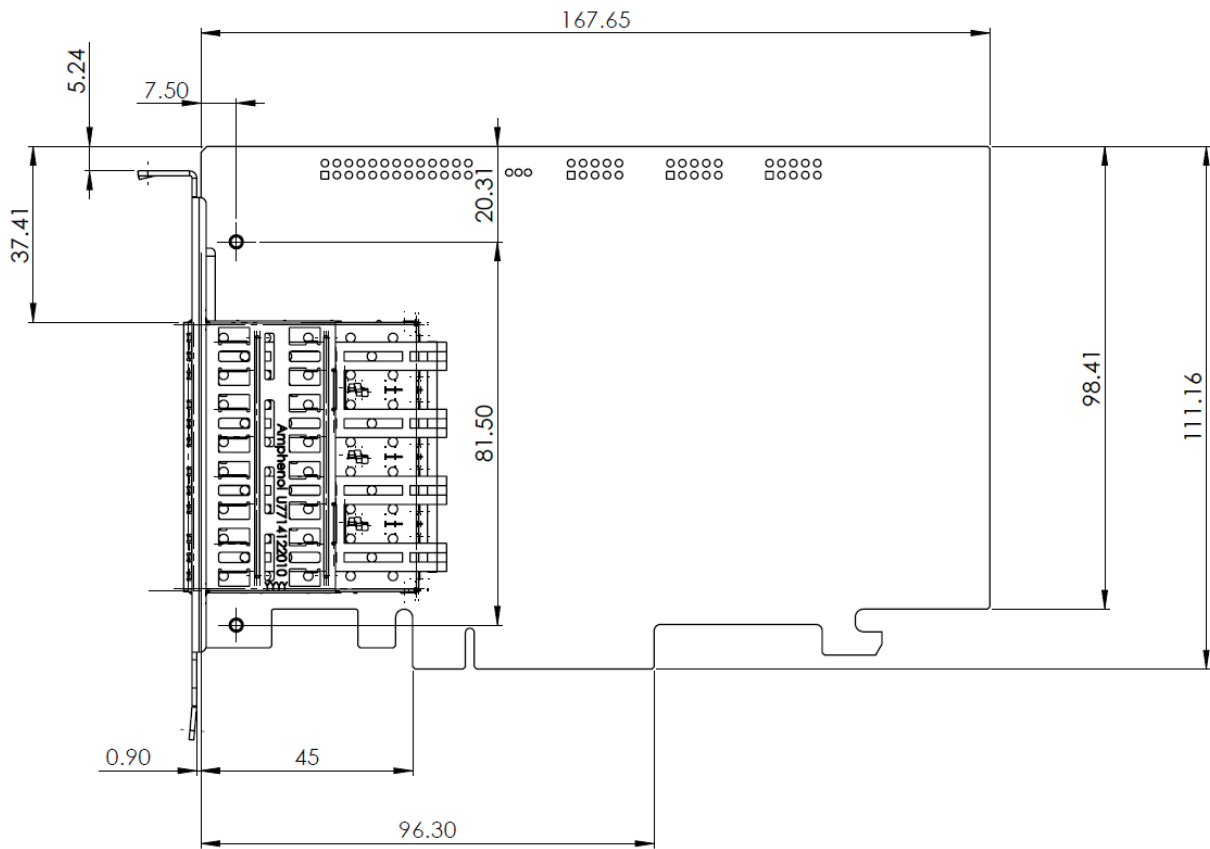

10.2 Weight & Environmental Conditions

Table no. 21 lists the weight of each card:

Card	Weight
Predator II CoaXPress	~ 130 [gr]
Chameleon II CoaXPress	~ 225 [gr]
Komodo II CoaXPress	~ 225 [gr]
Komodo II CLHS	~ 225 [gr]

Table 21 – Card's weight

Storage and operating temperature are identical for all four cards:

Specification	Value
Storage temperature	-55°C to 125°C
Operating ambient temperature	0°C to 50°C

Table 22 – Absolute maximum temperature ratings

11 Power Specification

11.1 Absolute Maximum Ratings

Specification	Values
3.3V power supply	-0.3V to +3.7V
12V power supply	-0.3V to 14V

Table 23 – Absolute maximum electrical ratings

Card	Minimum voltage [V]	Maximum voltage [V]
LVDS	-0.3	3.6
Opto-isolated (in)	-6.0	60
Opto-isolated (out)	-7.0	70
TTL	-0.5	6.5
LVTTL	-0.5	6.5

Table 24 – Absolute maximum ratings for GPIO

12 Installation & Configuration

12.1 Installation Instructions

Our cards can be installed onto any PCIe connector of the supported PCIe standard (See Table 2 – PCIe working modes)– PCIe working modes. It is important to note that your card should be installed **before** you install your software.

Installation steps are as follows:

1. Before installing, turn off the power of the computer and its peripherals.
2. Use an ESD-preventive glove, wrist or ankle strap and follow its instructions for use.
3. Make sure there is no dust or any other foreign matter inside the PCIe slot and the Frame Grabbers PCIe connector, or blocking any of the connectors
4. Firmly insert the card board to the PCIe connector of the motherboard.
5. Anchor the PCIe bracket to the computer chassis using M3 screw.
6. Verify the card is inserted correctly to the PCIe slot.
7. Connect external power supply to dedicated connector (Komodo II CoaXPress and Predator II CoaXPress).
8. Power on the computer.
9. After OS is up, you will be asked to install a driver for new Multimedia Device.
At this stage, you should Cancel the installation.

The compatible drivers for your card will be installed during the installation of our Vision Point software (Windows and Linux only). Multiple cards can be installed and used on a single computer – the exact number depends on the number of available PCIe slots.

12.2 CoaXPress Cards

Our CoaXPress cards (**Komodo II CoaXPress**, **Chameleon II CoaXPress** and **Predator II CoaXPress**) implement CoaXPress standard Micro-BNC connectors for CoaXPress interfaces. When attaching cables to your card you must use 75Ω coaxial cables. For best performance, it's recommended to use high quality cables, such as Belden 1694A and Belden 4855A.

If you are using more than single cable to connect to the same card, the cables you use must be of the same type and length.

12.2.1 Installing and Removing Micro-BNC Cables

Connecting a Micro-BNC cable is simple and straightforward. First, notice a pin on the male-connector. An “L” shaped channel is cut-out from the female connector. When connecting the cable push the connector onto the male-end, making sure the pin and channel align. There should be no need to apply much pressure and it is advised to avoid doing so as to not cause unnecessary damage to the cable or the card.

Figure no. 12 illustrates the process:

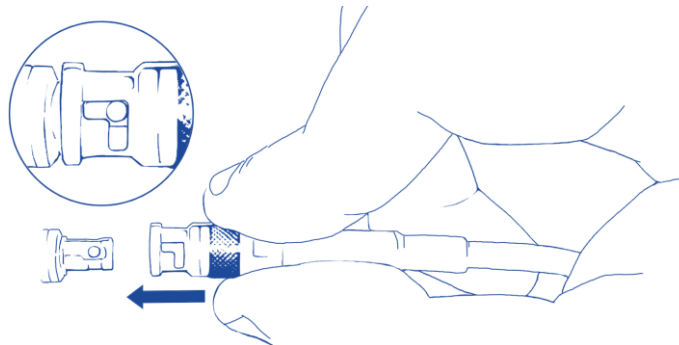

Figure 12 – Pushing the Micro-BNC connector into place

Once pushed all the way through, twist the connector clock-wise. The pin will move in the channel locking the connector in position:

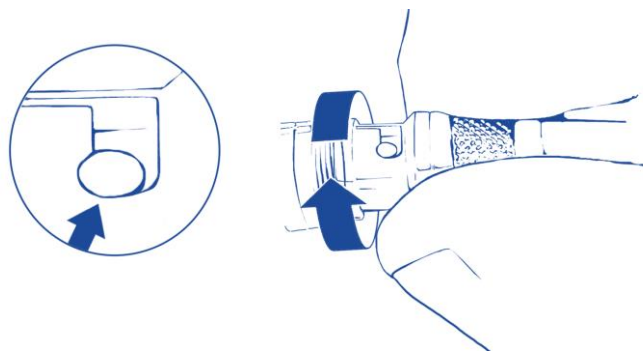

Figure 13 – Twisting the connector and securing it in position

To remove the cable, repeat the process from finish to start: twist the connector counter-clock-wise and pull it out. Do not force the cable out! If you feel resistance check for the pin location in relation to the channel. Adjust as needed and only then pull the cable out.

12.3 CLHS Cards

12.3.1 Installing & Removing SFP+ Modules

The purpose of this section is to demonstrate how to install SFP+ transceiver module, attach an optical network cable and remove an SFP+ transceiver module. It is necessary to understand the correct way of installing and removing an SFP+ transceiver, as correct operation can protect the module from being damaged and ensure its stable performance. Before removing or installing an SFP+ module, please follow the precautions and installation instructions.

12.3.2 Precautions

1. Use an ESD-preventive wrist or ankle strap and follow its instructions for use.
2. Make sure there is no dust or any other foreign matter inside the SFP+ module, or blocking any of the connectors.
3. Clean the optic surfaces of the fiber cables before plugging them into the optical ports of an SFP+ module.
4. Removing and inserting a module can shorten its useful life, so you should not remove and insert the module any more often than is absolutely necessary.
5. Insert the clean dust covers into the module after the cables are removed. Do not remove the dust plug until you are ready to attach the network interface cable.
6. Do not install or remove the SFP+ module with fiber-optic cables attached to it because of the potential of damaging the cable, the cable connector, or the optical interfaces in the module.
7. Disconnect all cables before removing or installing a module.
8. Place the removed module on an antistatic mat or a static shielding bag if you plan to return it to the factory.
9. Protect the line card by inserting clean module cage covers into the optical module cage when there is no module installed.
10. Keep the protective dust plugs installed in the unplugged fiber-optic cable connectors and in the transceiver optical bores until you are ready to make a connection.

12.3.3 Installing the SFP+ Module

In order to install the SFP+ module, follow these steps:

1. The Komodo II CLHS Frame Grabber supports the following SFP+ modules:
 - KY-SFP-10G31-10 – Allows of up to 10km connection over single mode fiber cable.
 - KY-SFP-10G85-3M – Allows of up to 300m connection over multi-mode fiber cable.
2. Remove the dust plugs from the module as shown in figure 14 (a).
3. The SFP+ module has a bale clasp that used to remove or install the SFP+ module.
4. Close the bale clasp before inserting the SFP+ module.
5. Line up the module with the port and slide it into the port as shown in figure 14 (b).
6. Make sure that the male connectors on the module will align with the female connectors inside the cage.
7. Verify that the modules are completely seated and secured in their assigned receptacles on the line card by firmly pushing on each module. In case the module is not completely seated and secured in the receptacle, you will hear a click as the triangular pin on the bottom of the module snaps into the hole in the receptacle.

8. Follow the exact steps to insert additional module into the camera's fiber interface.

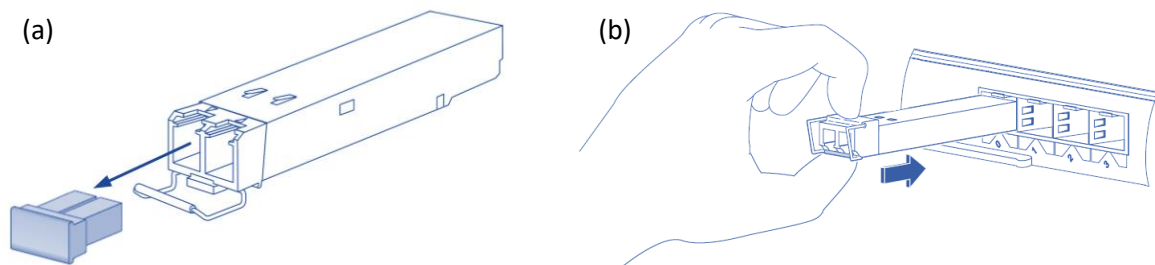

Figure 14 – SFP+ Module Installation.

(a) bale clasp open and dust plug removed, (b) Installing an SFP+ Module into a port

12.3.4 Connecting the Interface Cable to the SFP+ Module

In order to properly connect the fiber optic cables, the following steps must be taken:

1. Remove the protective dust plugs from the fiber-optic cable connectors.
2. Perform the connection according to the instructions below:
 - a. Link 0 of the system must be always connected as controls are delivered with this port.
 - b. A Fiber connection must be done to the same port number all over the way from camera to Frame Grabber.
 - c. A fiber cable should match an SFP+ type. If a single mode SFP+ is used a single mode fiber (yellow) should be attached to it. If a multi-mode SFP+ is used a multi-mode fiber (orange) should be attached.
 - d. On Fiber channel 0 both the TX and RX fiber cables must be connected. On channels 1 through 3 only one fiber cable should be connected. This cable is connected between TX output (Marked with TX or Arrow outwards the SFP+) on the camera and RX input (Marked with RX or Arrow inwards the SFP+) on the Frame Grabber, as shown in figure 15 (a).
 - e. If more than a single cable is used to connect to the same Frame Grabber, the cables must be of the same type and length.
3. Insert the fiber cable into the module, as shown in figure 15 (b).
4. Firmly push on each cable, until you will hear a click.
5. Connect the other side of the fiber cables to the camera's SFP+ module.
6. Turn the camera and the computer on and start your Vision Point software application.

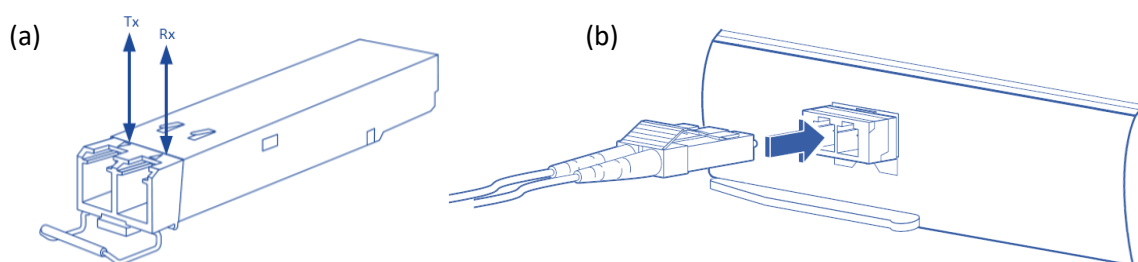

Figure 15 – Interface connecting to the SFP+ Module

(a) SFP+ module with TX output and RX input marked, b) Connecting the cable to SFP+ Module

12.3.5 Removing the SFP+ Module

1. Turn the camera and the computer off.
2. Disconnect and remove all interface cables from the ports.
3. Open the bale clasp on the SFP+ module with your index finger, or a small flat-blade screwdriver, in a downward direction, as shown in figure 15.
4. Grasp the module between your thumb and index finger and carefully remove it from the port, as shown in figure 16.
5. Insert the clean dust covers into the module, as shown in figure 17.

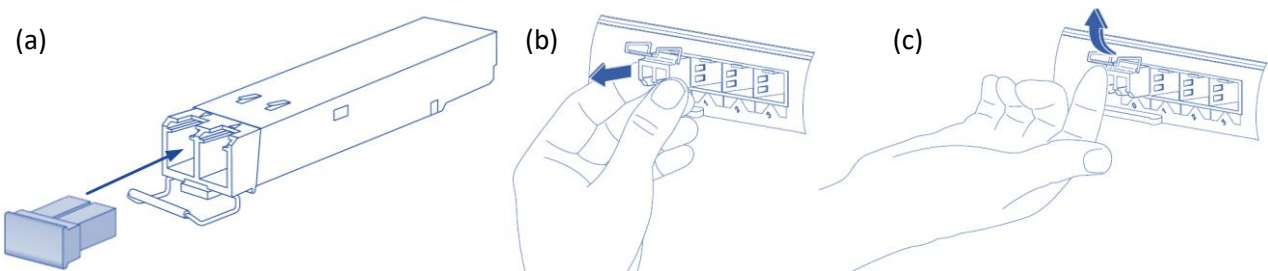

Figure 16 – Removing the SFP+ Module

(a) Opening the bale clasp of an SFP+ Module, (b) Removing an SFP+ Module from the port, (c) SFP+ Module with bale clasp open

12.4 Camera Connection Topologies

The komodo II CoaXPress, Komodo II CLHS and Chameleon II CoaXPress frame grabbers support multiple modes of configuration and system topologies:

Single Camera Topology:

Single, dual or quad links with a maximal bandwidth of 12.5 GB/s per link (10GB/s for the CLHS). Total maximal throughput to PCIe is card dependent, see Table 2 – PCIe working modes.

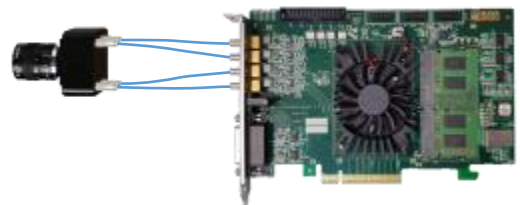

Figure 17 – Single camera topology

Dual Camera Topology:

Two single or dual links with a maximal bandwidth of 12.5 GB/s per link (10GB/s for the CLHS). Total maximal throughput to PCIe is card dependent, see Table 2 – PCIe working modes.

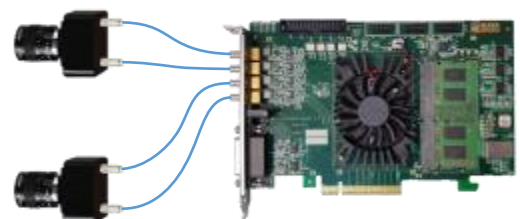

Figure 18 – Dual camera topology

Quad Camera Topology:

Four single links with a maximal bandwidth of 12.5 GB/s per link (10GB/s for the CLHS). Total maximal throughput to PCIe is card dependent, see Table 2 – PCIe working modes.

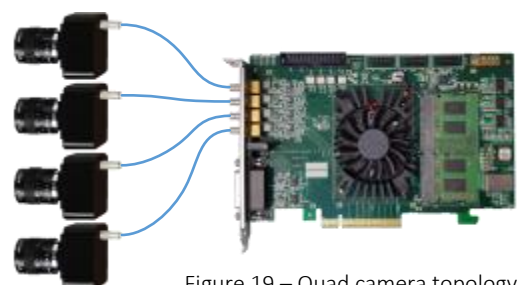

Figure 19 – Quad camera topology