

ADJUSTABLE COLLIMATING ADAPTER

UNIFORMITY OF SPOT SIZES from various light guides

Beam Profiles

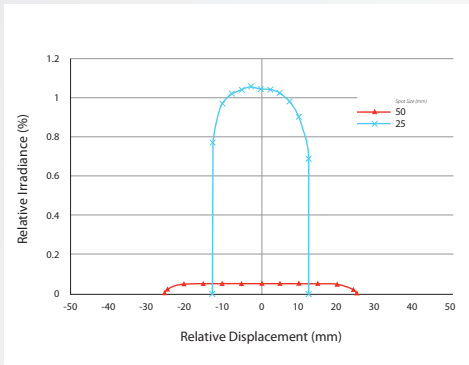

3mm Liquid Light Guide with Adjustable Collimating Adaptor		
SPOT SIZE (mm)	DISTANCE AWAY (cm)	IRRADIANCE mW/cm ²
50	38.20	7.22
25	19.40	135.00

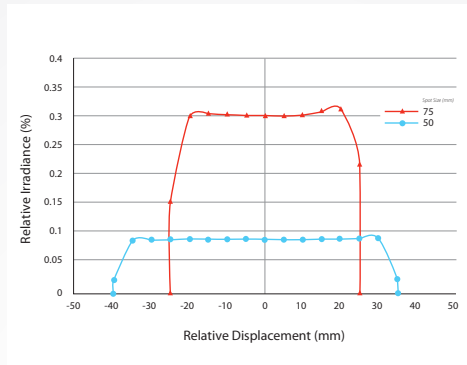

5mm Liquid Light Guide with Adjustable Collimating Adaptor		
SPOT SIZE (mm)	DISTANCE AWAY (cm)	IRRADIANCE mW/cm ²
75	57.02	10.02
50	22.10	70.00

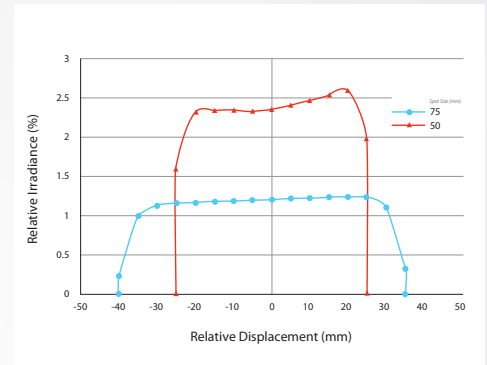

8mm Liquid Light Guide with Adjustable Collimating Adaptor		
SPOT SIZE (mm)	DISTANCE AWAY (cm)	IRRADIANCE mW/cm ²
75	18.80	74.50
50	14.70	184.00

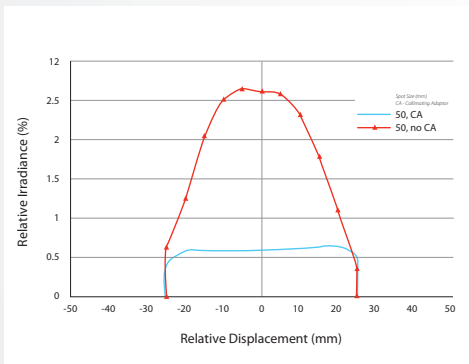

8mm Liquid Light Guide with/without Adjustable Collimating Adaptor		
Spot Size (mm)	DISTANCE AWAY (cm)	IRRADIANCE mW/cm ²
50 (without CA)	3.50	707.00
50 (with CA)	14.70	184.00

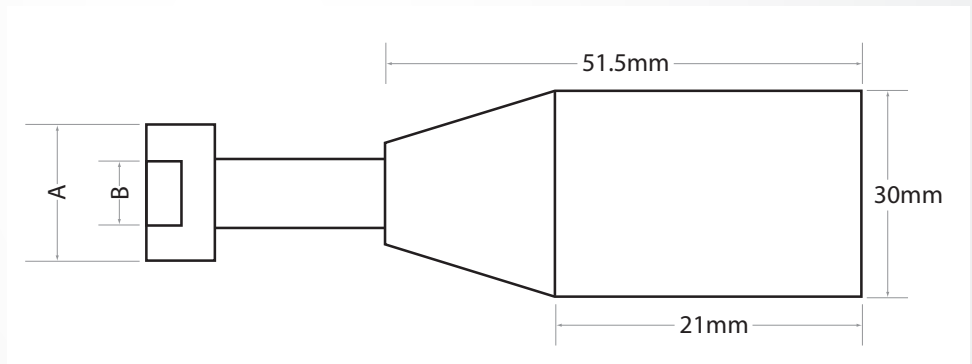

Light Guide Holder Dimensions				
		A	B	C
3mm	mm	17.78	9.25	12.7
	inches	0.70	0.36	0.50
5mm	mm	17.78	10.21	12.7
	inches	0.70	0.40	0.50
8mm	mm	21.59	14.99	13.79
	inches	0.85	0.59	0.54

As you can see, you can achieve a uniform distribution of light by using an Adjustable Collimating Adaptor.

NOTE: All measurements were taken with an LDGI R2000 Cure Site Radiometer.

NOTE: All dimensions are shown in inches and millimeters. Dimensions relate to standard LDGI Adjustable Collimating Adaptors and are for the purpose of providing fixturing and clearance details. Customized solutions are available upon request.

For 3mm, 5mm and 8mm Adjustable Collimating Adaptors, Part Numbers: 810-00041, 810-00042, 810-00043