

QXF17

IPL Cosmetic Flashlamps, Linear, 900Ws, Quartz

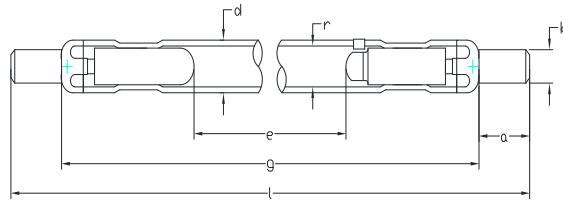

Dimensional Specifications (mm)

Arc Length (e)	Glass Body Length (g)	Overall Length (l)	Glass Diameter (d)	Radius (r)	Base length (a)	Base dia. (b)
50mm	114mm	140mm	6mm dia.	4mm dia.	13mm	4.75mm

Notes: lamps are Rohs compliant

Operating Specifications:

Max. Power P_{max}/W		Trigger coil TR	ZS 1324(H)
Nom. Power P_{nom} / W		Trigger capacitor $C_z/\mu F$	0.47
Max. flashenergy E_{max}/Ws	900	Min. trigger voltage $U_z \text{ min}/V$	250
Nom. flashenergy E_{nom}/Ws		Trigger contact S	SCR
Max. anode voltage U_{amax}/V		Flash frequency/Hz	1~4
Nom. anode voltage U_{anom}/V	300	Life/Number of flashes/N	11-100K
Min. anode voltage U_{amin}/V		Repetition rate t_{rep}/s	
Nom. flash capacitor $C_B/\mu F$		Sec trigger voltage $U_z \text{ sec} / KV$	-ve
Light reduction after life/ %		Unloaded	

For a complete listing of our global offices, visit www.excelitas.com/locations

© 2021 Excelitas Technologies Corp. All rights reserved. The Excelitas logo and design are registered trademarks of Excelitas Technologies Corp. All other trademarks not owned by Excelitas Technologies or its subsidiaries that are depicted herein are the property of their respective owners. Excelitas reserves the right to change this document at any time without notice and disclaims liability for editorial, pictorial or typographical errors.